



# Oco Pro Dome Setup Guide



# Hi, I'm Oco!

I'm very easy to install.

However, if you have any questions, don't hesitate to contact our 24/7 support team at

[support@getoco.com](mailto:support@getoco.com),

or call us at **1-888-683-8950** (English only).

# Content

Setting up your Oco .....	5
Mounting the camera.....	7
Adding Cloud Storage.....	11
Activating Micro SD card.....	12
Granting Access to Other Users .....	13
Adjusting notifications settings .....	14
Adjusting the sensitivity of the motion sensor..	14
Integrating Other Smart Devices via IFTTT .....	15

# Setting up your Oco

1. Log into your account at [www.ivideon.com](http://www.ivideon.com) (If you do not have an Ivideon account yet, please visit [www.ivideon.com](http://www.ivideon.com) and sign up). Go to “My cameras” tab and click “Add a camera or a DVR”.
2. Choose “Ivideon-powered camera”. Follow the instructions.
3. Create a name for your camera, then enter your camera MAC address.
4. Connect one Ethernet cable to the LAN IN port of your router, and connect the other to the LAN port of the PoE injector.
5. Connect the second Ethernet cable to the PoE port of the PoE injector, and connect the other end with the camera.

*Note: Don't connect the power adapter to a power socket before you will be prompted!*

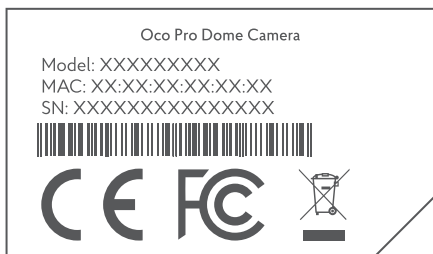

*The Mac Address can be found on the sticker on the back of your camera*

6. When prompted, plug the PoE power adapter into the power outlet and click “Next”. Oco will boot and connect to the cloud.
7. Please be patient, the connection could take up to several minutes.
8. Once the camera is connected, you will be prompted to set up the WiFi connection. You can always set up the WiFi connection later, just click “Settings” icon of the selected camera (hamburger icon) and choose “WiFi settings”. Choose your WiFi network and enter the password for the network. Once the camera is connected to your WiFi, you can unplug the the Ethernet cable from you router/switch.
9. Download Ivideon App for your smartphone and log in with your Ivideon account.

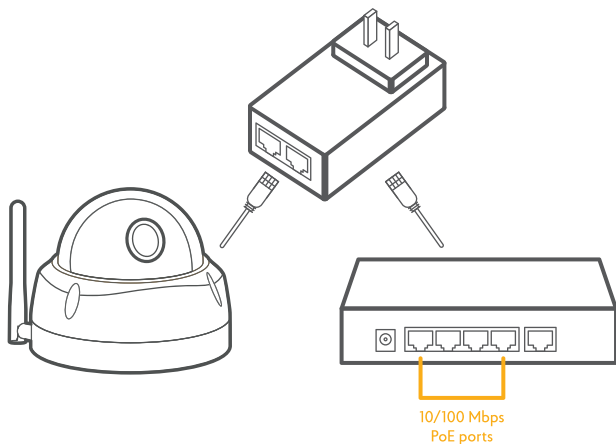

# Mounting the camera

*Note: Before the installation, please make sure the installation environment can at least support 3x weight of the camera.*

1. Use inner hex wrench in the accessories bag to open dome enclosure by unfastening three inner hex screws on enclosure.

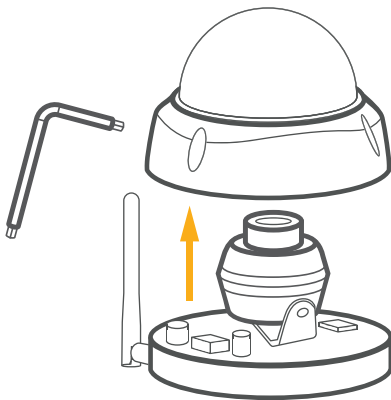

2. Please take out the installation position map in the accessories bag, and then paste it on the ceiling or the wall according to your monitor area requirements.

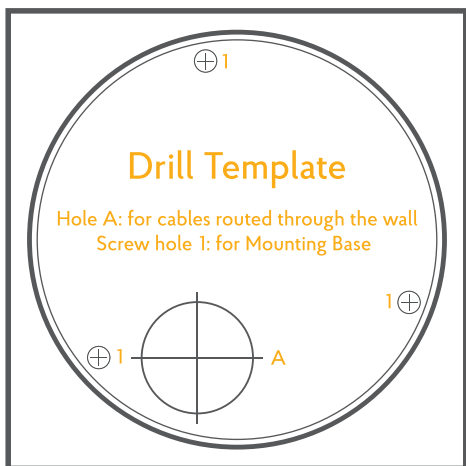

3. Find cross signs on the map, and dig three plastic expansion bolts holes on the installation surface and then insert three expansion bolts in the holes. Secure these three bolts firmly.



*Note: If user pulls out cable from top of installation surface, you must dig an exit hole on installation surface according to the installation position map. If user pulls out cable from side of cable channel, it must go through the U-shape channel on dome pedestal, and take out cable from the side exit hole on pedestal.*



4. Adjust the device installation pedestal to the proper position and then pull cable through the exit hole on Installation surface. Make direction of TOP sign same as it on installation position map. Line up the three screw holes in the device pedestal to the three plastic expansion bolt holes in the installation position. Put the three self-tapping screws in the three plastic expansion bolts firmly. Fix dome body on installation surface.

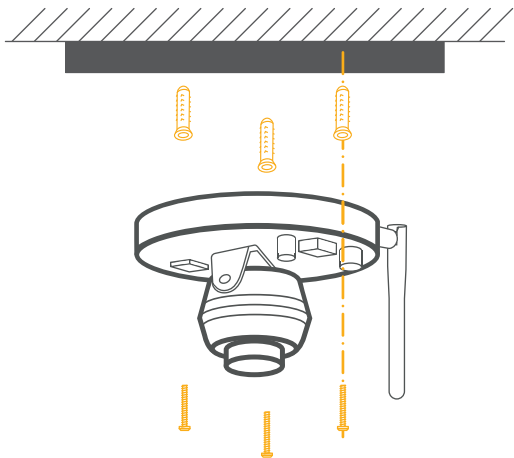

5. Hold both sides of the rotation bracket bottom with hands, rotate horizontally along the axis, and adjust lens horizontal direction to designated position. Hold the LED decoration cover with hand, rotate along the vertical direction, adjust the lens vertical direction to designated position; it is okay to loosen the fix screws on both sides of the bracket first if it is too tight to adjust (just make it loose, do not take it down), then adjust the lens, tighten the fix screws after adjustment. Hold the LED decoration cover with hands, rotate horizontally along the axis, and adjust the lens image to designated position. Range of lens: vertical ( $0^{\circ}\sim+64^{\circ}$ ), horizontal ( $0^{\circ}\sim+355^{\circ}$ ), image rotation direction ( $0^{\circ}\sim+355^{\circ}$ ).

*Note: When it rotates to  $64^{\circ}$  vertically, please pay attention to the image rotation direction in order to avoid the outer cover blocking IR light and influencing IR effect.*

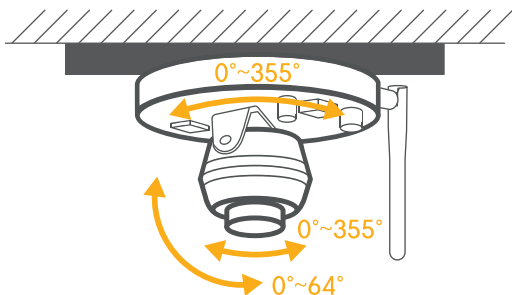

# Adding Cloud Storage

1. Sometimes you'll want to add more people to your account, or you'll need to store data for a longer period. That's no problem, our Cloud plans can help.
2. You can activate extended Cloud Recordings by choosing one of the Ivideon's price plans (learn more at [getoco.com](https://getoco.com)).
3. Open the Ivideon App. Choose Camera Settings → Cloud Archive, and follow the Setup Wizard.

*Note: if you are using the camera for home monitoring and don't see our Free Plan, then please contact [support@getoco.com](mailto:support@getoco.com) for manual activation.*

# Activating Micro SD card

1. With Oco Pro, you can use Micro SD card as a local backup storage. Please note that the Data will be processed in the Cloud and can only be accessed using the Ivideon App. Oco supports Micro SD cards up to 128 GB with speed class 6 or higher.
2. Loosen the set screw on the front cover to disassemble the camera with the supplied inner hex wrench. Insert the card and put the cover back.

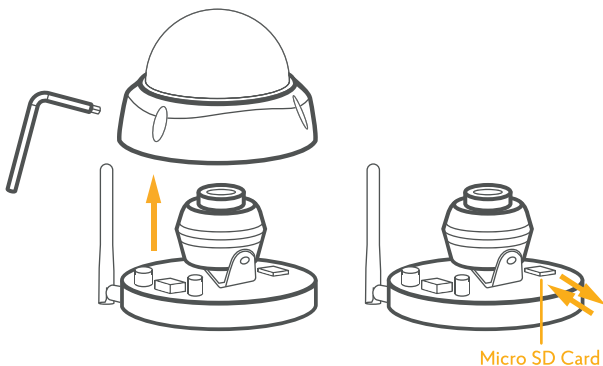

3. Reboot the camera by turning the power off and on again.
4. The timeline with archive recordings should appear in the App.
5. To check that the camera is working, turn off your router, walk in front of the camera, and then turn the router on again. The event video should appear on your timeline.

## Granting access to other users

1. You can use this feature if you wish to grant access to your Oco camera to other users.
2. In the App, choose your Camera and then tap Camera settings → Grant access

# Adjusting notifications settings

1. You can choose which types of notifications you would like to receive – e-mail, push, or both.
2. In your Ivideon app, choose Camera and tap Camera settings → Notifications (Settings)

# Adjusting the sensitivity of the motion sensor

1. Oco uses an intelligent self-learning algorithm to avoid false notifications. It literally gets smarter every hour you use your camera.
2. However, if you'd like to adjust sensitivity of the sensor manually, then open your Ivideon App, choose Camera and tap Camera settings → Motion

# Integrating Other Smart Devices via IFTTT

1. With IFTTT, your Oco camera can communicate with other smart devices, or function according to your geolocation, weather, or even the moon phase.
2. To setup IFTTT integration, download the IFTTT App, create an account and follow the App instructions.
3. Use one of the existing recipes or create your own at [http://ifttt.com/oco\\_camera](http://ifttt.com/oco_camera)

Follow us for product updates,  
security tips, and special deals.



getococamera